

KATO ADV Radio | Remote-controlled Actuator 230V

KATO ADV Radio is the radio-controlled evolution of the KATO family.

- It has the same body but a different and evolved intelligence. Complete with a radio frequency receiver integrated in the actuator body, it is suitable for installation wherever there is a need for remote control, through the PIK Radio Remote Control unit with rolling code technology.
- It can be connected to a bidirectional up-down switch.
- Use together with the NRS1 rain detector allows automatic closing of the window by wire signal in the event of rain, without need for additional control units.

PATENTED

EP1723303 - EP1723304B1



MODEL

KATO ADV RADIO

| | |
|---|--------------------|
| Thrust and traction force | 300 N |
| Strokes | 110/200/300/400 mm |
| Syncro ³ synchronization | NO |
| Power supply voltage | 110-230V ~ 50/60Hz |
| Rated absorbed current | 0,31-0,24 A |
| Power absorbed at nominal load | 23-27 W |
| No load speed | 15,7 mm/s |
| Duration of no load stroke | 25 s |
| Electrical insulation | Class II |
| Type of service | 2 cycles |
| Working temperature | -5°C - +65°C |
| Protection index for electrical devices | IP30 |

| | |
|--|----------------------------------|
| Soft Stop | NO |
| Relax function | YES |
| Adjustment of connection to window frame | Automatic definition of position |
| Connection in parallel | YES |
| Length of power cable | 2 m |
| Stroke-end at opening | Electronic by dip-switch |
| Stroke-end at closing | At absorption of power |
| Protection against overload | At absorption of power |
| Dimensions | 386,5x59x37 mm |
| Weight | 1 Kg |

APPLICATIONS

VASISTAS FRAME
OUTWARD FRAME
PIVOTING FRAME
DOMES
SKYLIGHTS
ROOF FRAME

| CODE | MODEL |
|---------|-------------------------|
| 6030580 | KATO ADV Radio black |
| 6030581 | KATO ADV Radio white |
| 6030582 | KATO ADV Radio grey |
| 7505021 | NRS1 Heated Rain sensor |
| 7505025 | PIK Remote control |

IMPORTANT: remote control and rain sensor are provided separately.



TECHNICAL CHARACTERISTICS (Functional and mechanical features)

- Electric actuator with a double-row four-link articulated chain enclosed in a sturdy composite material housing (glass fibre-reinforced polyamide). Suitable for opening awning windows, hopper windows, dome rooflights and dormers.
- Traction and thrust power 300N. Powered by 110-230V~ 50Hz or, alternatively, 24V DC Safety ELV (SELV) voltage.
- Supplied complete with screw-less quick coupling actuator mounting brackets (patented) and quick coupling/release awning or hopper window brackets (patented)
- Stroke-end: electronic opening stroke-end with variable strokes that can be selected at any time with the dip-switches. Closing stroke-end with power absorption
- Can be connected in parallel. Complies with EU directives (EMC Directive, Low Voltage Directive).
- Standard colours: Black (ref. RAL9004) with black power cable, White (ref. RAL9003) and Grey (ref. RAL7047) with white cable.

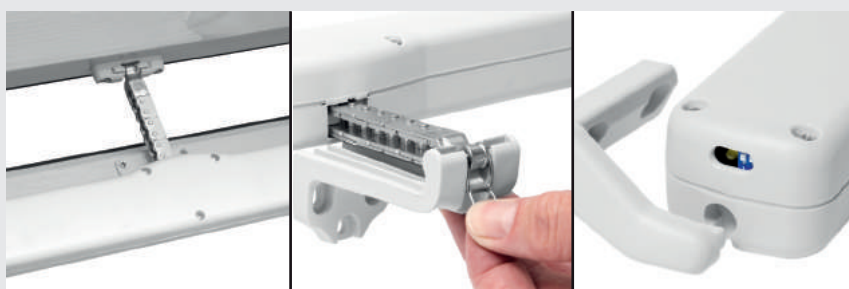
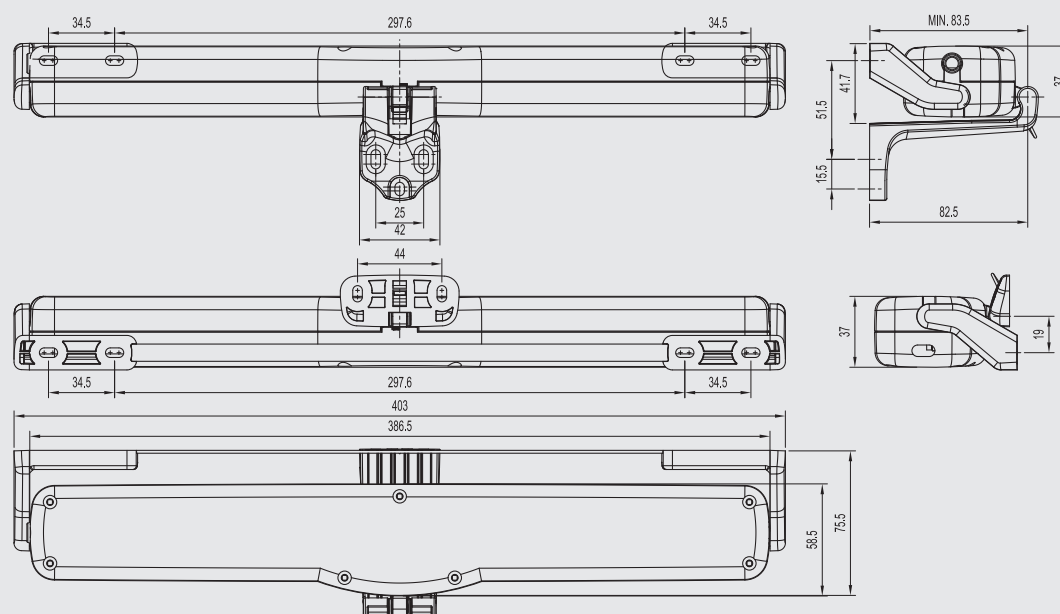

TO BE USED WITH:

KATO and KATO SYNCRO³ 24V:
BK-LOCK
SERIE KL and KL-R
MODIX 2/4/6
MY-SUN1 and MY-SUN3

KATO and KATO SYNCRO³ 230V:
SERIE KH and KH-R
RR2-M

KATO ADV RADIO 230V:
PIK
NRS1